

A Social Evening for Neurodivergent Adults

What to Expect



StanleyBlack&Decker

Walkthrough of Arrival & Check-in



When you arrive you should enter through a large gate. Parking in the museum parking lot is free. Rideshares can drop off inside the gate.

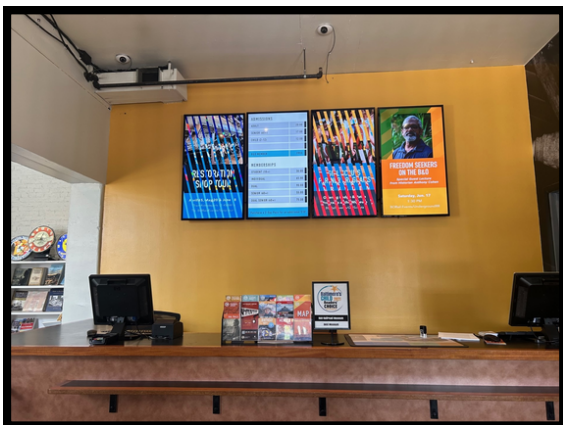

When you enter the museum a staff member will be at the desk to help with check-in. If you purchased your ticket before arriving they can check the ticket on your phone, if not you can purchase a ticket from the admissions staff member.



After check-in you can follow signs to enter the Roundhouse. From here you can access all event spaces.

Event Areas



The Roundhouse galleries will be open for you to explore. This space will also be a quiet space with no music.



The Backyard will have yard games available to play and lots of space to socialize. The museum cafe in the Backyard will be open to purchase snacks and drinks. You will be able to hear the music playing.



Under the Pavilion there will be music playing and space to dance if you like! There will also be picnic tables where you can sit to eat or socialize. Bar service will be available here.

Train Ride



A boarding announcement will be made over the museum speakers for the train ride, boarding will be on Platform 2. The train ride ticket was included in your admission cost.



Prior to boarding a safety announcement will be made, it can sound quite loud once you are on the platform.



Once on board the train please find a seat! Seating is not assigned but please follow directions given by the Conductor. You will hear the safety bell and whistle occasionally.



Social Evening Event Map

StanleyBlack&Decker

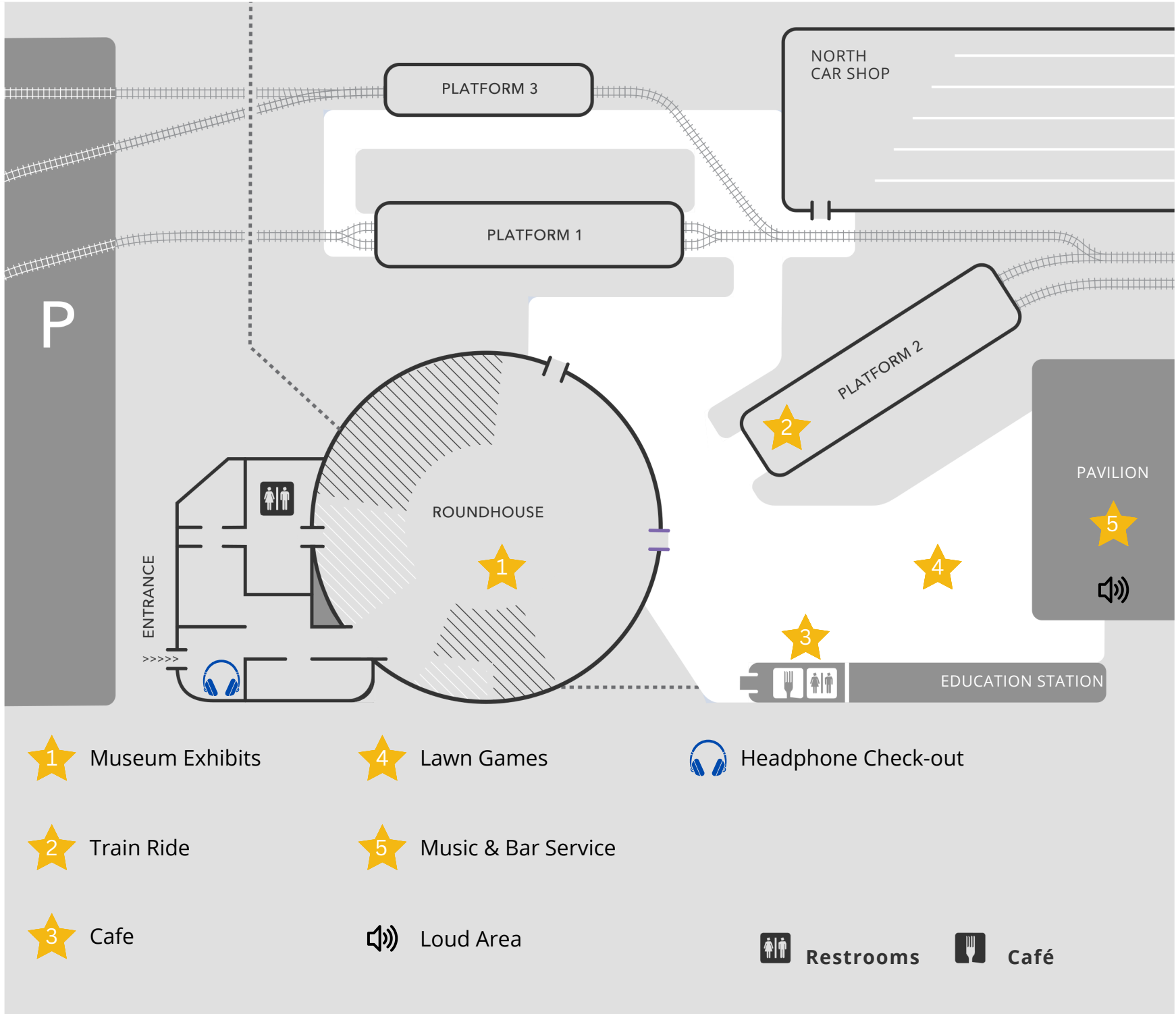

- ★ 1 Museum Exhibits
- ★ 4 Lawn Games
- 🎧 Headphone Check-out
- ★ 2 Train Ride
- ★ 5 Music & Bar Service
- ★ 3 Cafe
- 🔊 Loud Area
- 🚻 Restrooms
- 🍴 Café

FAQs & Contact Information

Where can I purchase tickets? How much are tickets?

Tickets can be purchased on the museum website or when you arrive to the event.

Who is this event for?

This event for adults 18 years old or older who identify as Neurodivergent. Bring along your friends for a fun night out at the B&O!

What time should I arrive?

The doors will open for the event at 5pm. You can arrive later that if you would like.

Do I have to stay for the entire event?

Nope! You can stay for as much or as little of the two hour event as you like.

Who should I contact if I have questions or need accommodations?

Contact our education team at edu@borail.org with any questions or accommodation requests.